

Model 750

Camber Axis Hinge

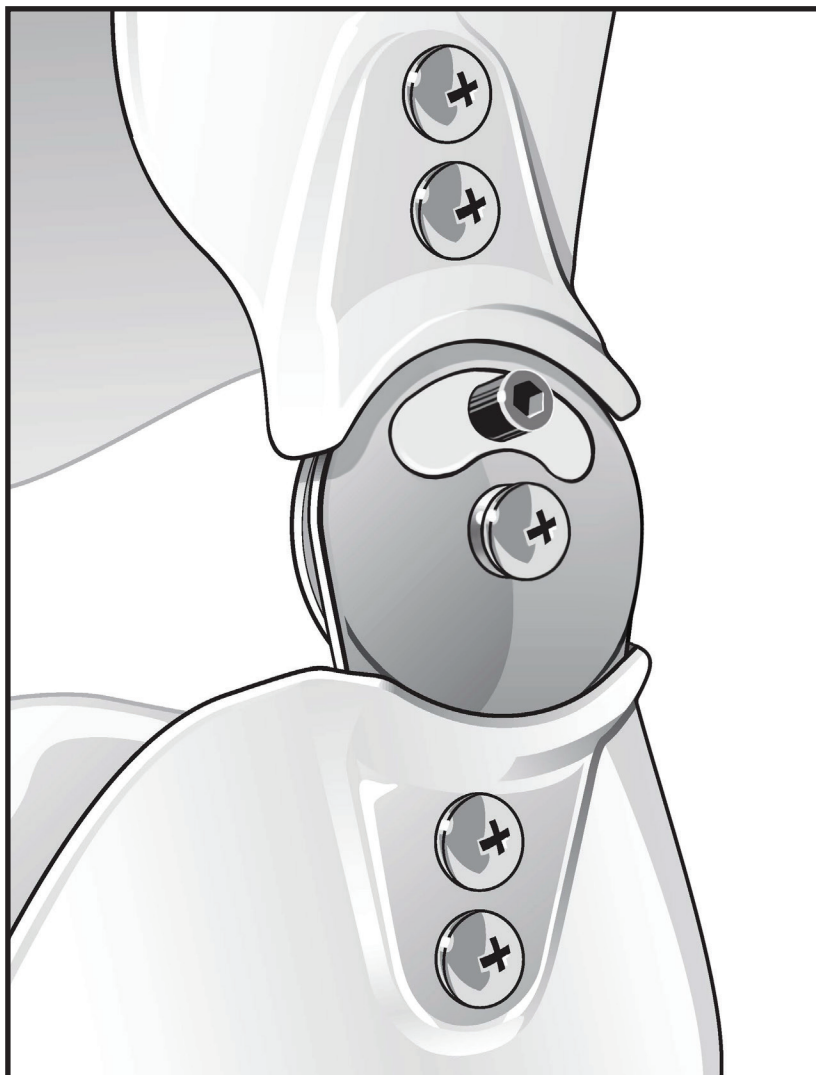

FABRICATION INSTRUCTIONS

Instructions

Model 750 Camber Axis Hinge



Fabrication Notes:

- Do not overtighten the #8-32 hex head key screw (3-5 inch pounds).
- Motion Keys #5, #6, #7 require a light machine oil lubricant for proper movement once positioned in the slot.
- The Camber Axis Small key stop mechanism is reversed when compared to Medium and Large joint designs. Range of motion settings are not affected by this configuration.

1. Prepare cast model and identify medial and lateral joint axis. Mark a vertical line through each axis perpendicular to the plantar surface of the cast.

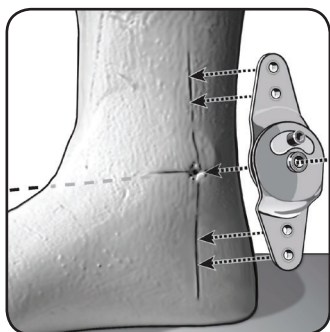

2. Properly size the CAH joint and contour by shaping to the cast. Align to the marked ankle joint axis. Squared alignment is not required, but keep mechanical joint centers approximately equal in height.

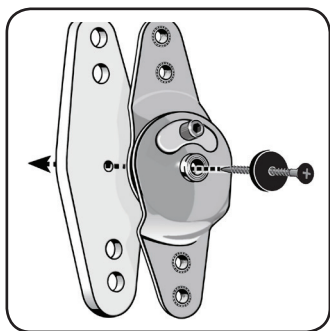

3. Fit the precut pelite fabrication blanks to the hinge. Remove the center axis screw and replace with the black plaster screw and washer. Carefully thread screw through the center axis and pelite blank.

Note: Extreme valgus or varus deformities of the foot/ankle must receive special consideration during alignment and fabrication to avoid pressures from the uprights and fasteners of the CAH. These areas must be well padded utilizing the enclosed interface pads, or by adding additional build-ups as determined by the orthotist.

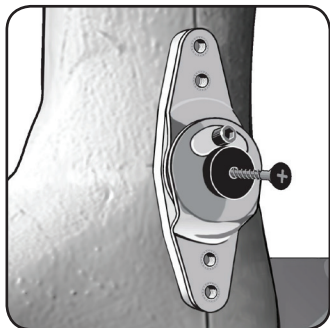

4. Drill 1/16" pilot holes at the joint axis on medial and lateral sides of plaster model. Align joints to the vertical lines, attaching hinges by tightening plaster screws until joints are flush with the cast surface.

Do not overtighten.

Fill any gaps with putty or plaster to prevent pulling plastic under the hinges.

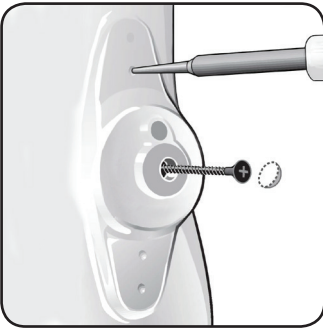

5. Stretch an interface nylon over the model and vacuum form to standard procedures. After thermoplastic has cooled, grind the plastic over the center axis screw head and remove plaster screws. "Hot mark" the center of each attachment hole before removing the AFO shell. Mark and cut trim lines to release AFO from cast.

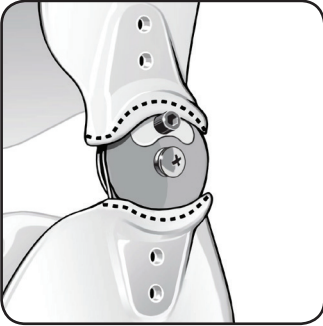

6. With the hinges removed, drill a #18 hole through "hot marks" centered at all clearance hole locations on the plastic. **Do not oversize clearance holes.**

Reinsert the hinges and mark trim lines for finishing at joint circumference before assembling AFO.

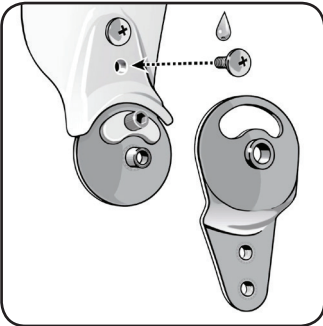

7. Insert hinges and assemble to AFO by securing #8-32 hinge attachment screws with threadlock. If required, careful peening of the #8-32 attachment screws will ensure permanent fixture in final assembly.

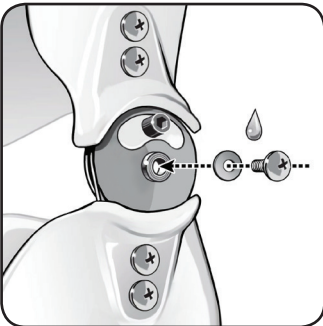

Important:

- Apply threadlock to all screws during final assembly.
- Use #8-32 x 3/8" screw when assembling thicker materials.

8. Place S.S. washer under the center axis screw head and torque the screw to 3-5 inch pounds.

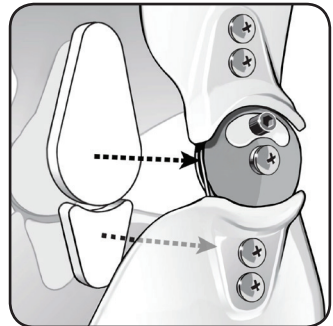

9. Apply pelite or adhesive-backed Aliplast pads as a soft interface between joints and the skin.

Range of Motion Settings

The foot/ankle position or desired range of motion can be set by inserting the appropriate keys as shown by the Key Identification Chart. Remember that all “R” and “L” keys can be interchanged and reversed for dorsi or plantarflexion motion control. Anatomical reference is “R” to the right side of the lower extremity and “L” to the left side. If the desired R.O.M. is not available in standard key sizing, grind the key to the desired degree setting.

Recommended Use of the Camber Axis Hinge

Component selection should be determined by the orthotist after considering individual patient weight and functional gait activities. Patient weight should not exceed 220 lbs. (99 kg).

The joints were designed for thermoformable applications.

If it is necessary to heat relieve the plastic, care should be taken not to distort the pre-determined ankle axis.

Key Identification Chart

Key	Side	Motion	Application	Color
#1	L/R	0°	Locked	Silver
#2	L/R	5°	Locked Plantar or Dorsiflexion	Red
#3	L/R	10°	Locked Plantar or Dorsiflexion	Blue
#4	L/R	15°	Locked Plantar or Dorsiflexion	Purple
#5	L/R	0° to 30°	Limited Plantar & Dorsiflexion Motion	Green
#6	L/R	5° to 10°	Limited Plantar & Dorsiflexion Motion	Black
#7	L/R	7.5° to 10°	Limited Plantar & Dorsiflexion Motion	Yellow

Recommended Weight Ranges for the Camber Axis Hinge

CAH-Small	750-S Under 80-100 lbs (36-45 kg)
CAH-Medium	750-M Under 160 lbs (72 kg)
CAH-Large	750-L Under 220 lbs (99 kg)

Component Schematic

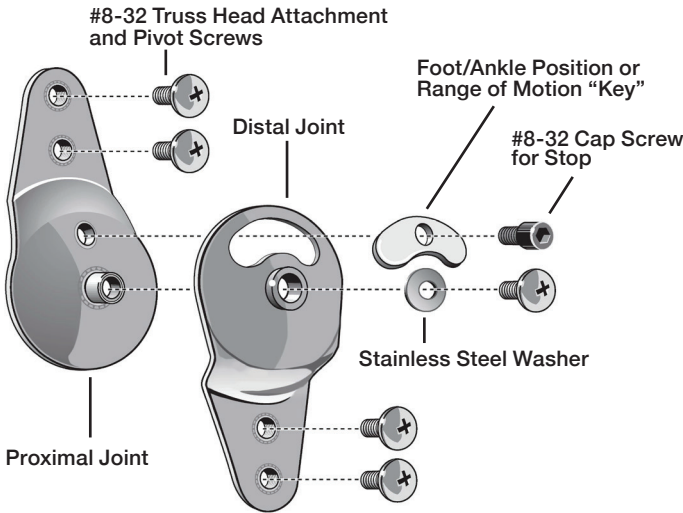



BECKER
A Tradition of Excellence A Commitment to Innovation



P: 800-521-2192 • 248-588-7480
BeckerOrthopedic.com | f t in

US Patent 5,542,774
Camber Axis Hinge is a trademark of
©2020 Becker Orthopedic Appliance Co.,
All rights reserved.
Revision 04/30/20

EC

REP

Acorn Regulatory Consultancy
Services Limited
Knockmorris Cahir Co. Tipperary
Ireland, Postcode: E21 R766
P 012 4626 8456
F 012 4626 8648

